

FLOOD

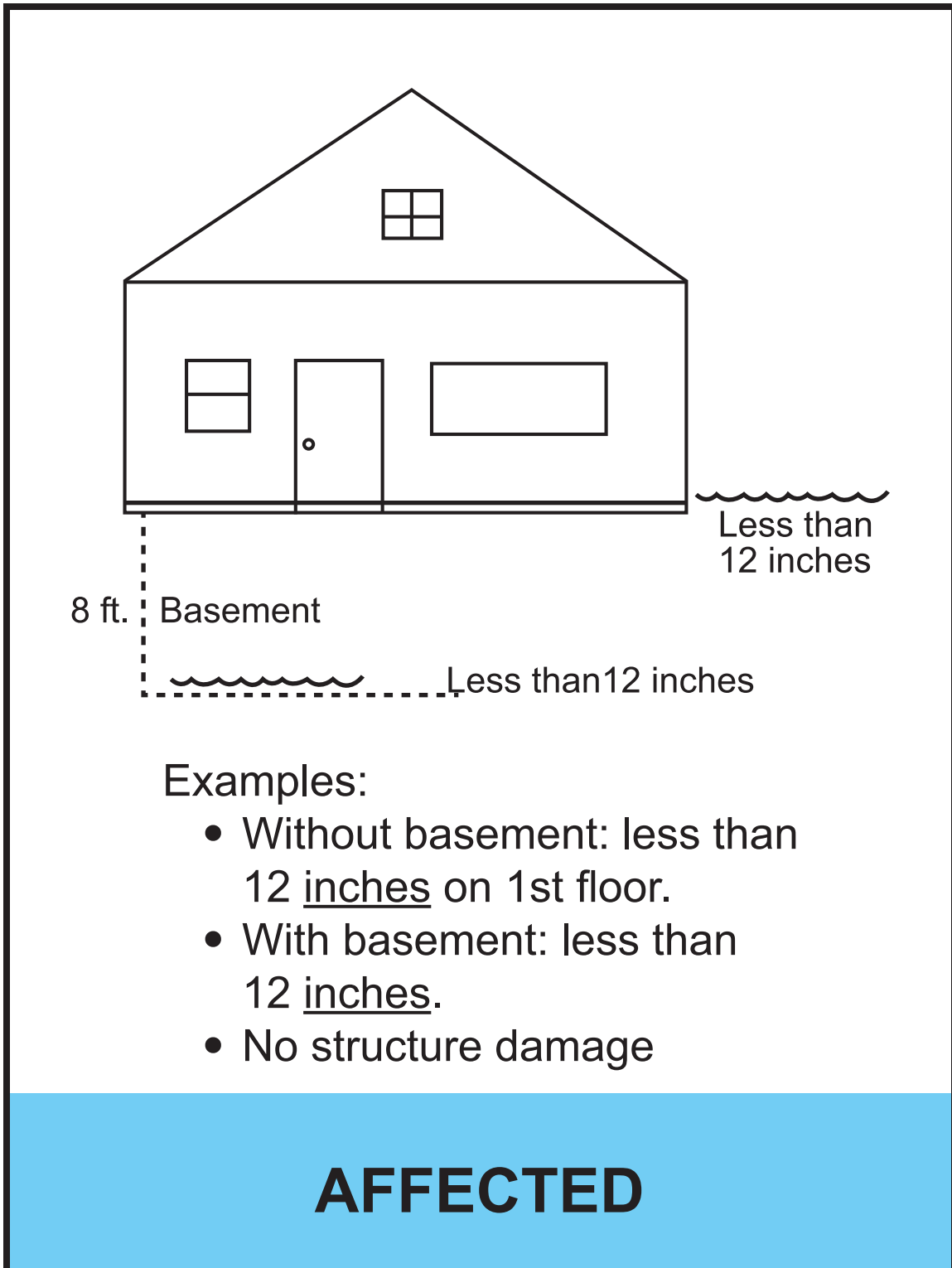

DAMAGE

FLOOD DAMAGE: SINGLE FAMILY DWELLING



FLOOD DAMAGE: SINGLE FAMILY DWELLING

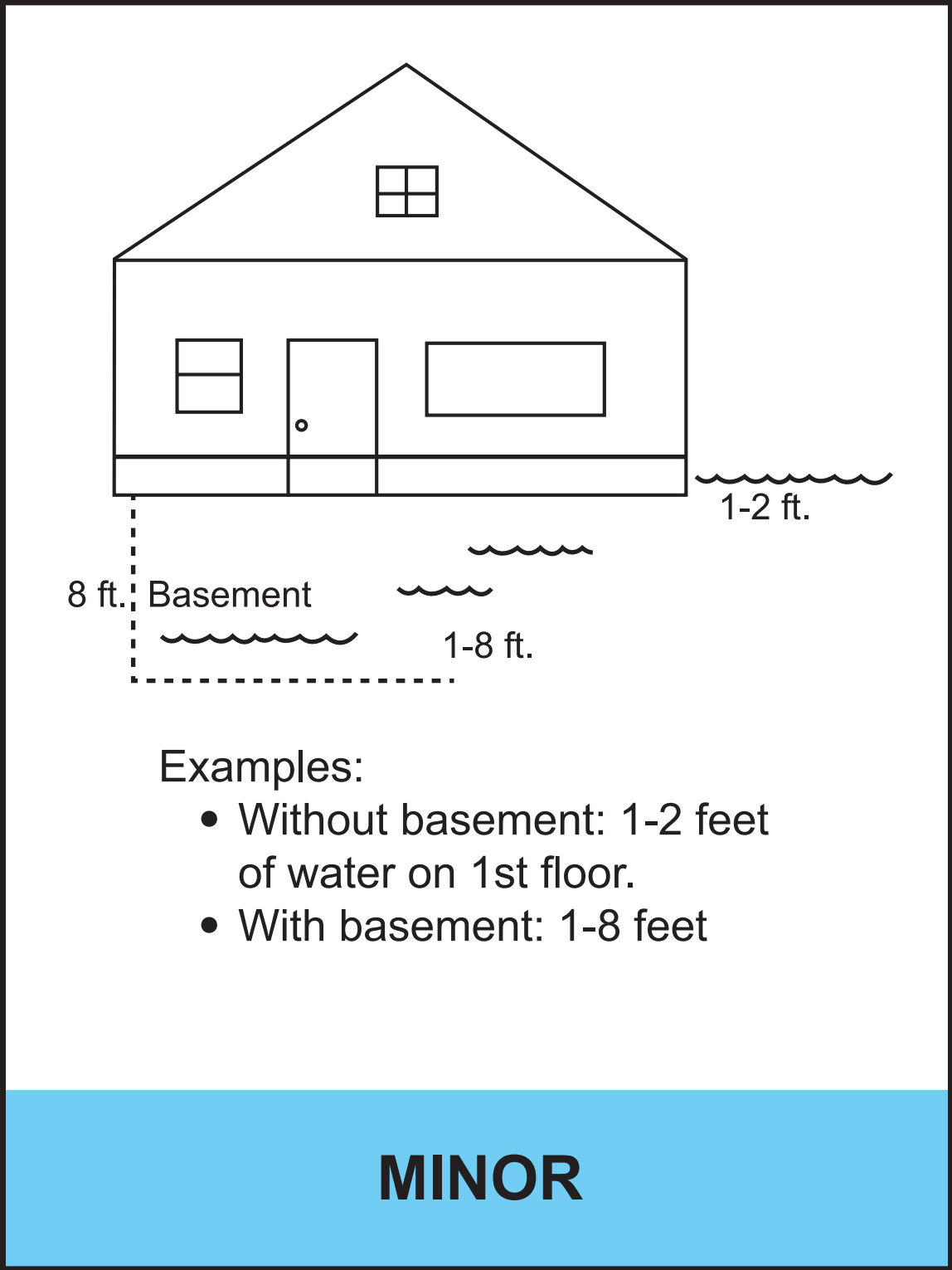

Examples:

- Without basement: 1-2 feet of water on 1st floor.
- With basement: 1-8 feet

MINOR

FLOOD DAMAGE: SINGLE FAMILY DWELLING

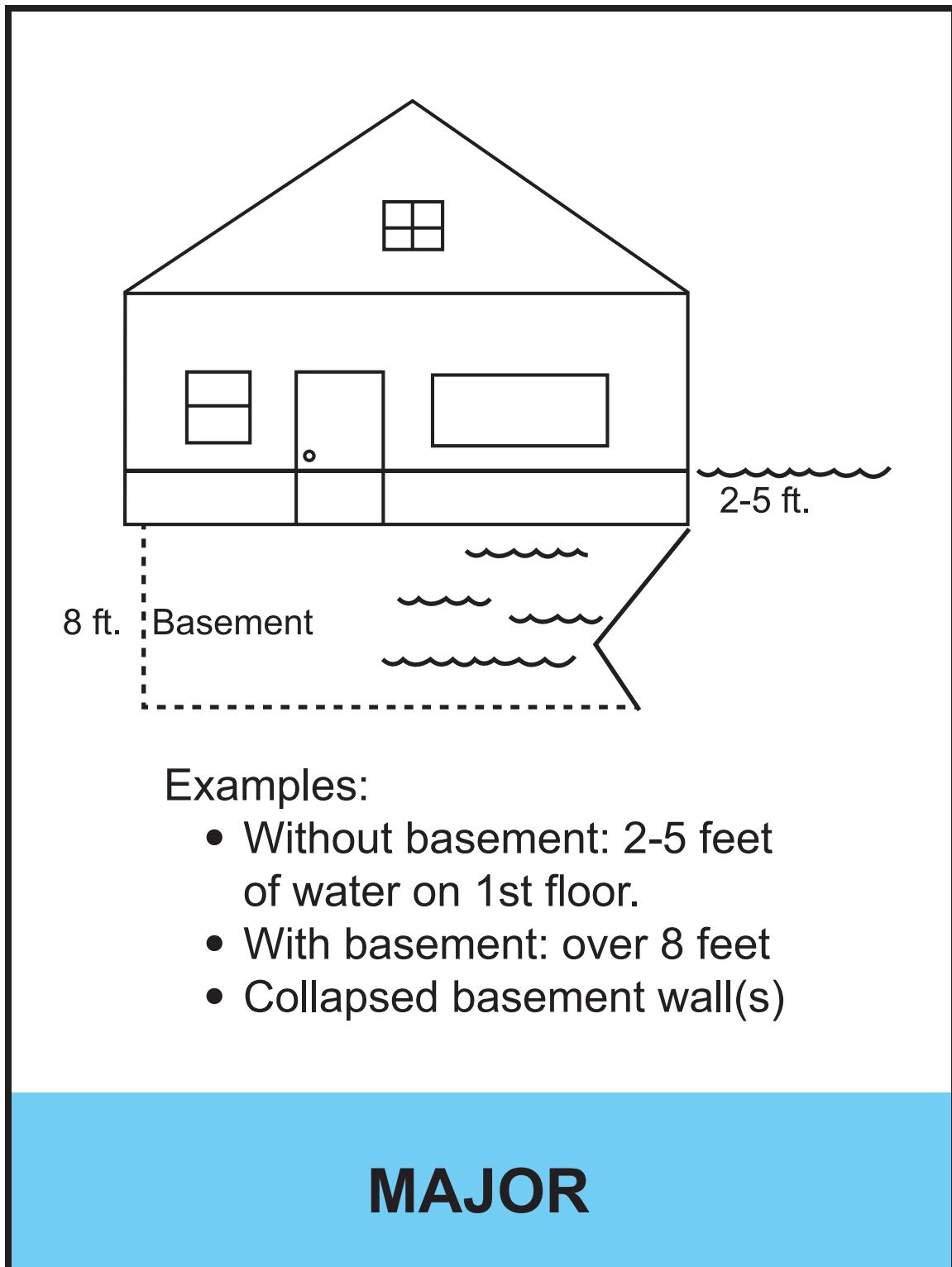

FLOOD DAMAGE: SINGLE FAMILY DWELLING

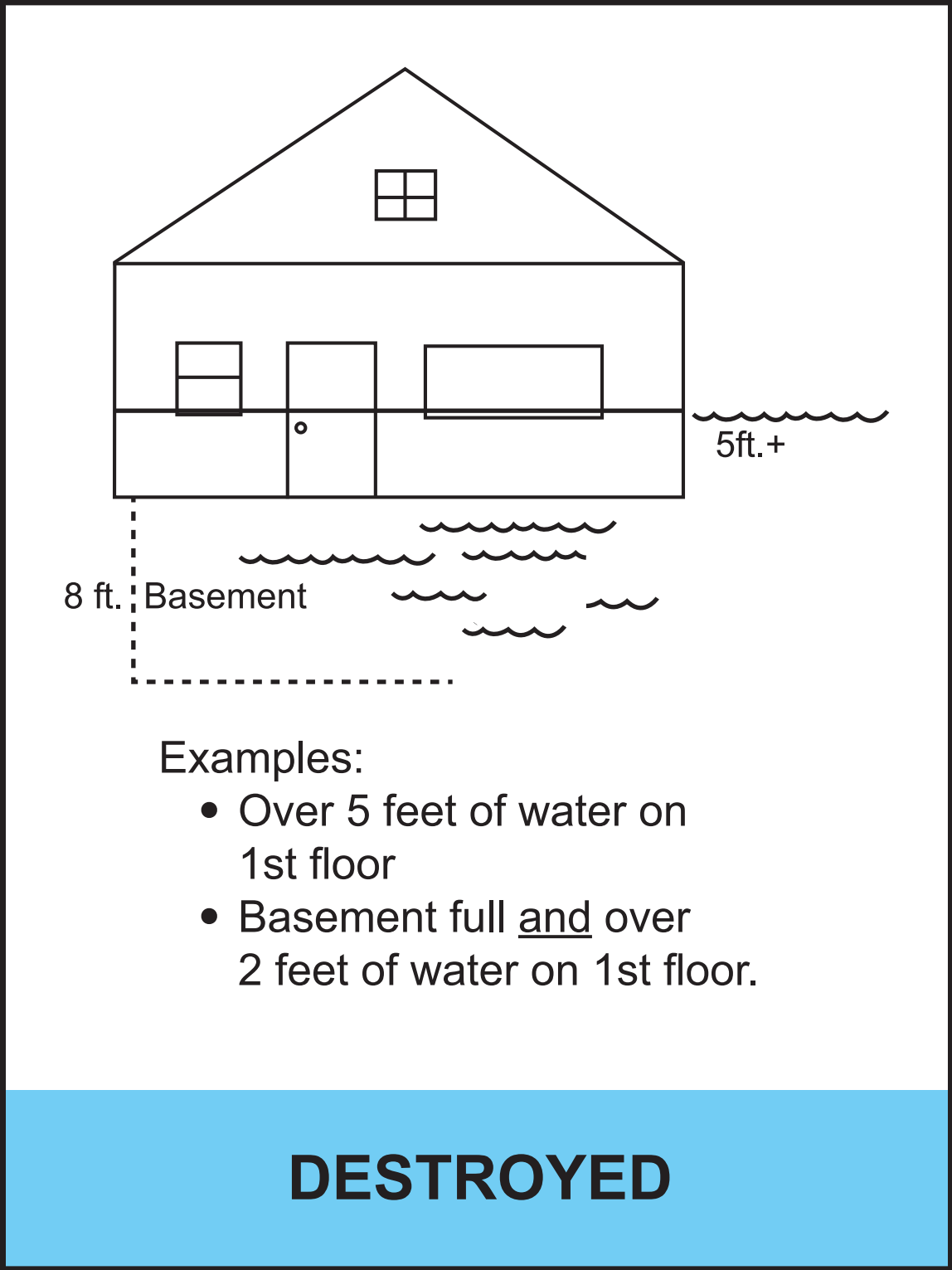

FLOOD DAMAGE: MOBILE HOME

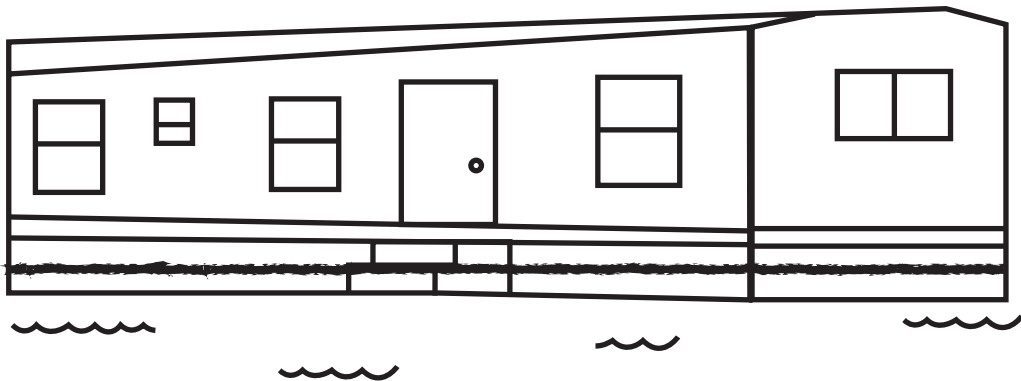

Examples:

- Water standing under or around mobile home, but not touching the bottom board.
- Indication of water being around a mobile home, but not touching the bottom board following a flash flood.

AFFECTED

FLOOD DAMAGE: MOBILE HOME

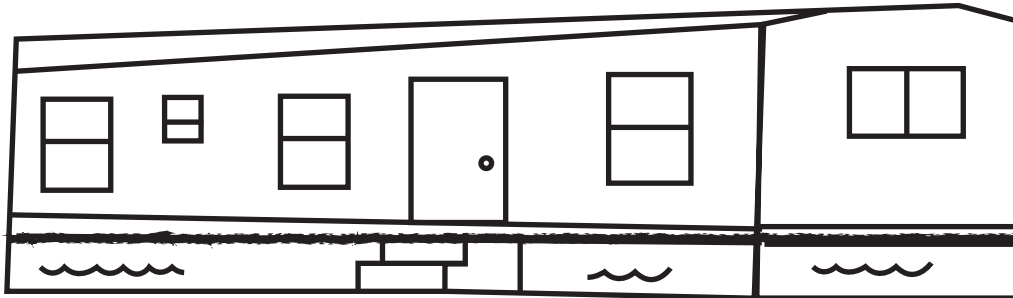

Examples:

- Utilities flooded
- Piers/foundation shifted
- Water touched or soaked at the bottom board, but did not enter the primary living area.

MINOR

FLOOD DAMAGE: MOBILE HOME

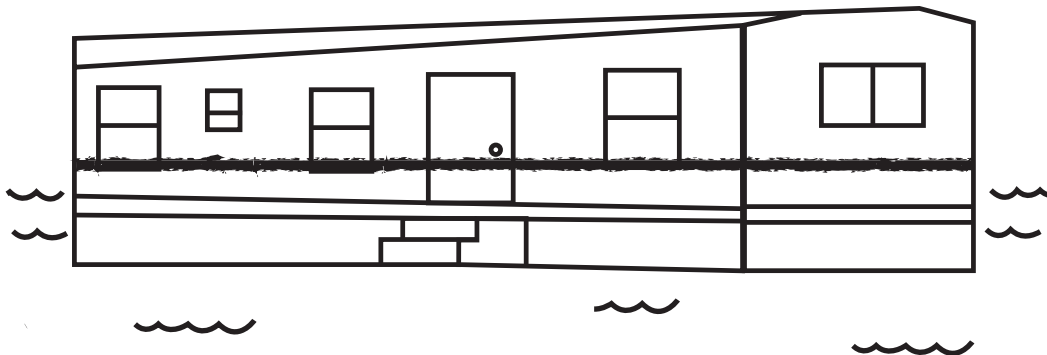

Examples:

- Water soaked bottom board and the primary living area.
- Piers/foundation washed out or away.

MAJOR

FLOOD DAMAGE: MOBILE HOME

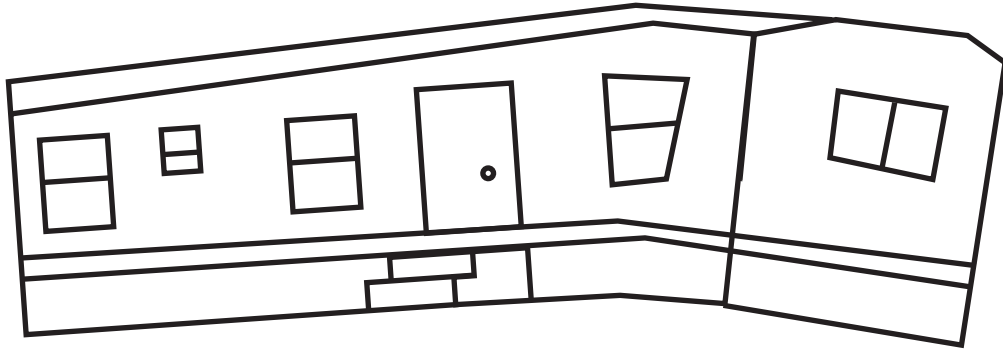

Examples:

- Washed off piers/foundation
- Frame bent or twisted.
- Mobile home has turned over on its side/top.
- 4 feet + water above floor level.

DESTROYED



Minnesota Department of Public Safety
Homeland Security and Emergency
Management

444 Cedar Street, Suite 223
St. Paul, MN 55101

Fax: 651-296-0459
www.hsem.state.mn.us